



HC ZY DY

CONTACT US

0921-341-5401

sales@nxsphil.com.ph

B14 L4 Unit 2 Varisha Building, Silcas Village Brgy. San Francisco, Binan, Laguna

Certificate

CERTIFICATE OF COMPLIANCE

Certificate Number 20180313-EX27773
Report Reference EX27773-20180310
Issue Date 2018-March-13

Issued to: Leyon Piping System Co., Ltd
 Suite 401 Building D No. 255 Meiqiang RD Minhang
 District 201104 Shanghai, CHINA

This is to certify that representative samples of FITTINGS, CAST IRON, DUCTILE IRON, MALLEABLE IRON AND BRONZE

Fittings, Cast Iron, Ductile Iron, Malleable Iron Fittings
 Model - , 90, 92, 90R, 120, 130, 130R, 130A, 130C, 180,
 180R, 241, 270, 240, 529, 280, 291, 301, 121, 220, 221
 130S, 130T, 300, 90S

Have been investigated by UL in accordance with the
 Standard(s) indicated on this Certificate.

Standard(s) for Safety: EN 10242 - Threaded Pipe Fittings in Malleable Cast Iron
 ASME B16.3 - Malleable Iron Threaded Fittings
 ASME B16.14 - Ferrous Pipe Plugs, Bushings, and
 Locknuts with Pipe Threads

Additional Information: See the UL Online Certifications Directory at
www.ul.com/database for additional information

Only those products bearing the UL Certification Mark should be considered as being covered by UL's
 Certification and Follow-Up Service.

Look for the UL Certification Mark on the product.

B. Mahesh
 Bruce Mahesholtz, Director North American Certification Program

UL LLC

Any information and documentation involving UL Mark services are provided on behalf of UL LLC (UL) or any authorized licensee of UL. For questions, please
 contact a local UL Customer Service Representative at <http://ul.com/about/contact>



CERTIFICATE OF COMPLIANCE

Certificate Number 20221019 - EX28919
Report Reference EX28919-20221019
Issue Date 2022-October-19

Issued to: SGF ENERGY ENGINEERING TECH. INC.
 1201 N Orange St Ste 600
 Wilmington, DE 19801-1171
 United States

This is to certify that representative samples of FITTINGS, WELDED OUTLET
 Models:

Have been investigated by UL in accordance with the
 Standard(s) indicated on this Certificate.

Standard(s) for Safety: UL 213B WELDED OUTLET FITTINGS FOR FIRE
 PROTECTION,
 ULC/ORD C213 WELDED OUTLET FITTINGS

Additional Information: See the UL Online Certifications Directory at
www.ul.com/database for additional information

Only those products bearing the UL Certification Mark should be considered as being covered by UL's
 Certification and Follow-Up Service.

Look for the UL Certification Mark on the product.

B. Mahesh
 Bruce Mahesholtz, Director North American Certification Program

UL LLC

Any information and documentation involving UL Mark services are provided on behalf of UL LLC (UL) or any authorized licensee of UL. For questions, please
 contact a local UL Customer Service Representative at <http://ul.com/about/contact>



Angle Hose

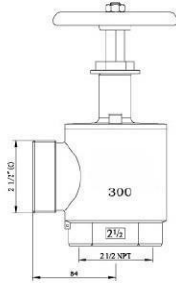

Size : 2 1/2"

Material :
Body:Brass
Handwheel:Iron with red painted
Finishes:Brass/Chrome/Polished

Features:
Male thread outlet

Specifications:
Working Pressure:300PSI

Approvals :
UL Listed/ULC Approval/FM Approval

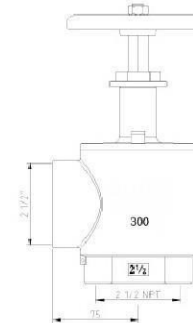

Size : 2 1/2"

Material :
Body:Brass
Handwheel:Iron with red painted
Finishes:Brass/Chrome/Polished

Features:
FeMale thread outlet

Specifications:
Working Pressure:300PSI

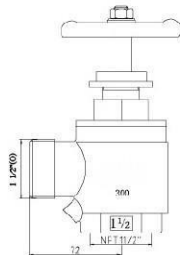

Size : 1 1/2" FxM

Material :
Body:Brass
Handwheel:Iron with red painted
Finishes:Brass/Chrome/Polished

Features:
Male thread outlet

Specifications:
Working Pressure:300PSI

Approvals :
UL Listed/ULC Approval/FM Approval

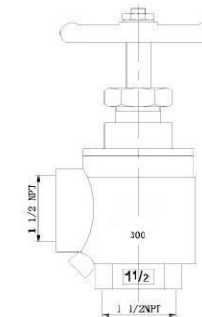

Size : 1 1/2" FxF

Material :
Body:Brass
Handwheel:Iron with red painted
Finishes:Brass/Chrome/Polished

Features:
FeMale Thread outlet

Specifications:
Working Pressure:300PSI

Approvals :
UL Listed/ULC Approval/FM Approval



Hydrant Gate Valve

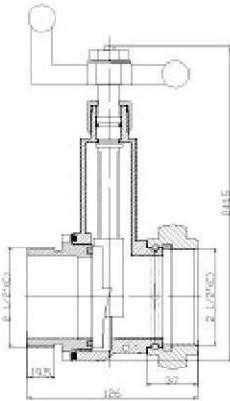

Size : 2 1/2" FxM
 Material: Body: Brass
 Handwheel : Lshape: iron
 Finishes: Brass
 Features: O-ring seal
 Specifications:
 Working Pressure: 300PSI

Stop Valve

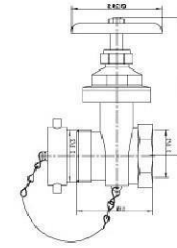

Size : 2 1/2" FxM

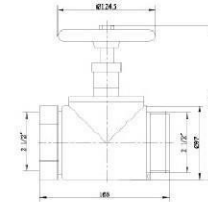

Size : 2 1/2" FxM

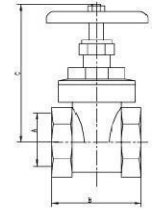

Size : 1/2" - 4" FxF

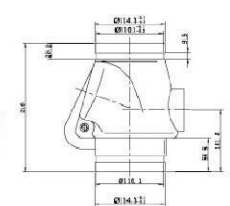

Size : 4" Cast Iron

Snoot

3" Female x 2.5" Hose Thread cast brass Check Snoot.
 Finish: Polished Brass or Polished Chrome

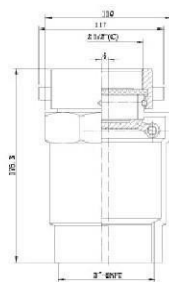
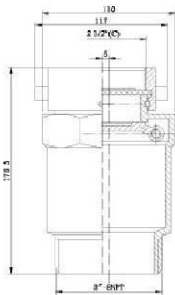

3" Female x 2.5" Hose Thread cast brass Check Snoot.
 Finish: Polished Brass or Polished Chrome

Stop Valve

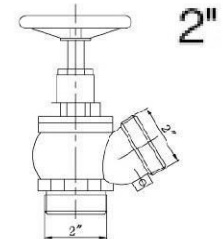

2"

Siamese Leader Line

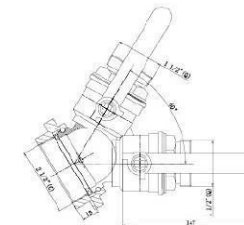

1 1/2" 1 1/2" 2 1/2"
 Female Swivel Hose Inlet x Male Hose Outlet Brass Leader
 Line Siamese.
 Painted red cast brass body
 Both rocker or pin lugs available with SS handles.

Test&Drain Valve

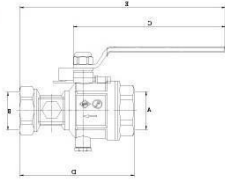

Size : 1" 1 1/4" 2"

Forged brass
Tapped for pressure gauge outlet.
Positive positioning of handle for test, drain & off.
Integrated sight glass.

Handle:SS
Finish:BRASS

Plastic Nozzle

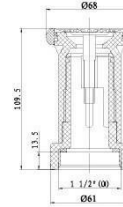

Size : 1.5"
Finish : Chrome Or Red



Ball Valve

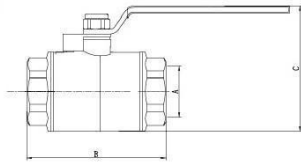

Size: 1/2" - 4"

Brass Nozzle

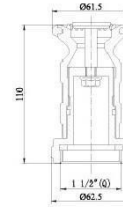

be used with 1-1/2" fire hose.
Finish : Chrome Or Red

ALum Nozzle



Size : 1.5"

Sprinklers



Type:Upright/Pendent/Sidewall

Dia : DN15

Response:SR&QR

Finish : Bronze/White Painted

Temperature:68°C K5,6



Comprehensive



Ball Drip
1/2"x3/4" Cast brass straight connection.



Brass Plug & chain
Size : 1 1/2" , 2 1/2"
Finish:brass/Chrome



Brass Cap & chain
Size : 1 1/2" , 2 1/2"
Finish:brass/Chrome



Hexagon cast brass hose connector.
Sizes : 1 1/2" x1 1/2" and 2 1/2" x2 1/2"
Finish:Brass/Chrome



Brass Reducer with either pin lug or rocker lug.
Sizes : 2 1/2" x1 1/2" , 2 1/2" x3/4", 2 1/2" x1", 2 1/2" x1 1/2", 2 1/2" x2"
Finish:Brass



Adaptor 6"x4" for Siamese



Residential Siamese
1.5" brass single inlet connection for residential systems
1 1/2" pin lug plug with chain
113.50.D. round plate, with swivel



Brass Adaptor
Female Swivel x Male-Pin Lug
Size: 2 1/2"
Finish: Brass/Chrome



Hexagon Swivel Hose Adaptor
Brass Female Swive x FeMale Pin Lug
Size : 2 1/2" Finish : Brass/Chrome



Brass Coupling with Brass Expansion Ring
Rocker Lugs on the female and male ends
Size: 1 1/2" Forged
FINISH : Cast Brass



2.5" adaptor with Male



2.5" adaptor with FeMale



Fire Hydrant Parts



Fire Hydrant Aluminum Parts
Long/Short



Pin Rack Nipple
Size : 1 1/2"
Finish: Brass/Chrome



Adaptor
Sizes : 1 1/2" x1 1/2" 2 1/2" x2 1/2"
Finish: Brass/Chrome plated



Adaptor
Sizes : 1 1/2" x1 1/2" 2 1/2" x2 1/2"
Finish: Cast brass.



Plastic Cap with Chain
Sizes : 2 1/2" Finish:red/Chrome



Plastic Cap & Chain
Sizes : 1 1/2" Finish:Red/Chrome plated



Plastic Cap with Chain
Sizes : 2 1/2" Finish:Red/Chrome



Trinal Wrench Cast Aluminum combination
1 1/2" and 2 1/2" Coupling Spanner



Hydrant Wrench



Alum Wrench with 7- 1/2" Length



Hydrant Wrench length:15"



Quick Plug
Alum
Plastic Plug



Fit over a standard cabinet latch
cast aluminum



Plastic Quick Plug



Adjustable Hydrant Wrench
2 1/2" Heavy Duty



Square Hydrant Wrench



Grip-All Spanner Wrench



Double Head Adjustable Hydrant Wrench
with length 19-1/2"
Ductile iron head with a deeply
Knurled chrome plated steel handle

Single Door Fire Cabinets

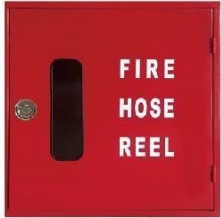

thickness of Cabinets can be changed upon clients request.

800x800x350mm
19mmx25/30m 25mmx25/30

thickness of Cabinets can be changed upon clients request.

570x270x210mm 4.5/6kg Fire Extinguisher
760x280x230mm 9-12kg Fire Extinguisher

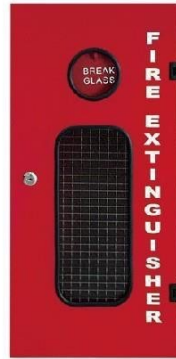

thickness of Cabinets can be changed upon clients request.
750x750x250mm 19mmx25/30m 25mmx25/30



Fire Hose Reel



Manual&Swinging
25mmx20m/25m/30m 750x750x250



Manual&Swinging Pige
19x20m/25m/30/36m 700x700x360



TPU FIRE HOSE

Light weight, ozone resistance, abrasion resistance,
Low-temperature resistance,
oil resistance, flexure resistance, friction loss less for maximum flow,
Long serving life.

DOUBLE SHEET FIRE HOSE

Double jackets, meeting higher pressure, abrasion high-resistance



PVC FIRE HOSE

Light weight, ozone resistance, abrasion resistance,
Low-temperature resistance, oil resistance, flexure resistance,
friction loss less for maximum flow, Long serving life.

Hose Rack



Material: Steel
Thread Size: 1-1/2"
Finish: Brass/chrome

CPLG



1 1/2" Brass CPLG&EXO. ring,
Brass/Chrome plated



1 1/2" Rack nipple
Brass/Chrome plated